



 x4

 x1

 x1



**Brays Lane  
Stoke  
Asking Price £175,000**



This double bayed, 4 bedroom, mid-terrace house is located in the Ball Hill area of Coventry and is close to shopping amenities, bus routes and Schools.

Currently rented at £750.00 per calendar month the property property briefly comprises of: Entrance hallway, ground floor double bedroom, lounge, kitchen, ground floor bathroom and three double bedrooms to the first floor.

The property offers further potential to add more bedrooms (subject to planning) and is and ideal investment purchase.

- EPC Rating: D
- Mid-Terrace House
- 4 Bedrooms
- Gas Central Heating & Double Glazing
- Further Potential To Add More Rooms
- Currently Let At £750pcm
- Close To Local Amenities

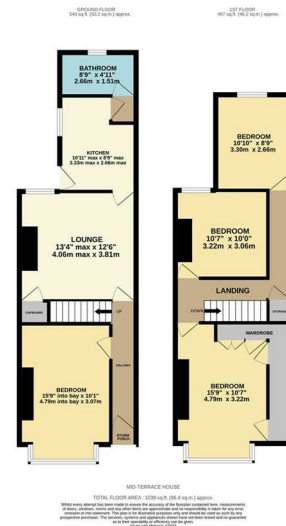

**PLEASE NOTE: General Information**

We have been informed by the vendor that the tenure of the property is Freehold. However, you are recommended to have this information verified by your legal advisor at the earliest opportunity. All measurements are approximate and quoted in metric and are for general guidance only and whilst every attempt has been made to ensure accuracy, they must not be relied on. The fixture, fittings and appliances referred to have not been tested and therefore no guarantee can be given that they are in working order. Internal photos are produced for internal general information and it must not be inferred that any item would be included within the sale.

**Elite Property**

**Sterling House, 112 Walsgrave Road, Stoke, Coventry, West Midlands, CV2 4ED**

**Tel: 024 7665 2200**

**www.eliteproperty.co**

